

**LICENSING KEY**  
 Licensable activities

**NOTES:**  
 Items shown on this plan which are not part of the statutory requirements are shown for indicative purposes only. This would include loose or fixed furniture in certain circumstances, the position of toilet cubicles, CCTV cameras and fire safety equipment not specified in the Regulations. These are shown upon the plans for illustrative purposes only and may be moved at the discretion of the license holder.

The current location of fire safety equipment and other safety equipment is shown. These may be subject to variation in the future as necessary and where applicable in liaison with the Fire Officer.

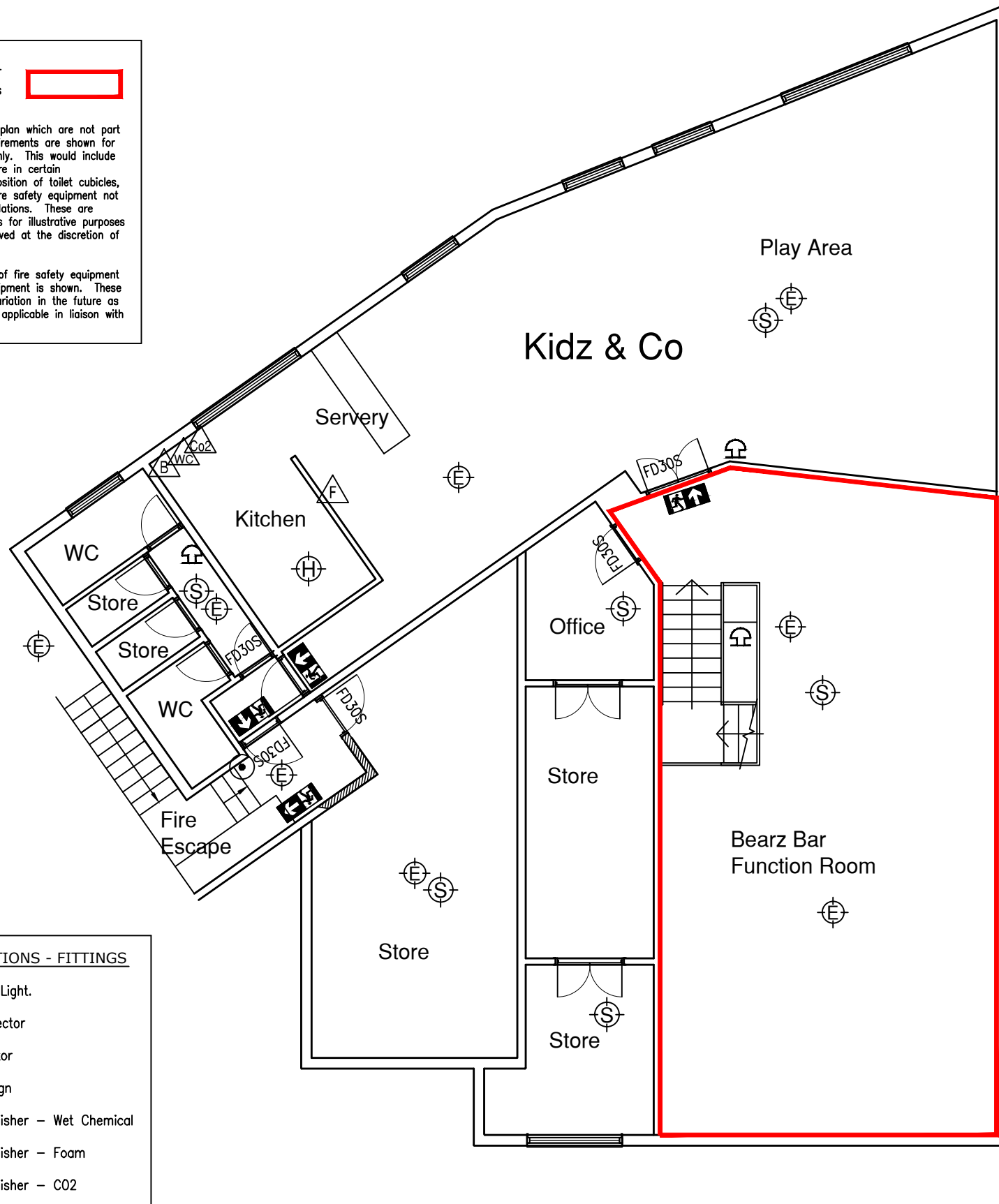

First Floor Plan

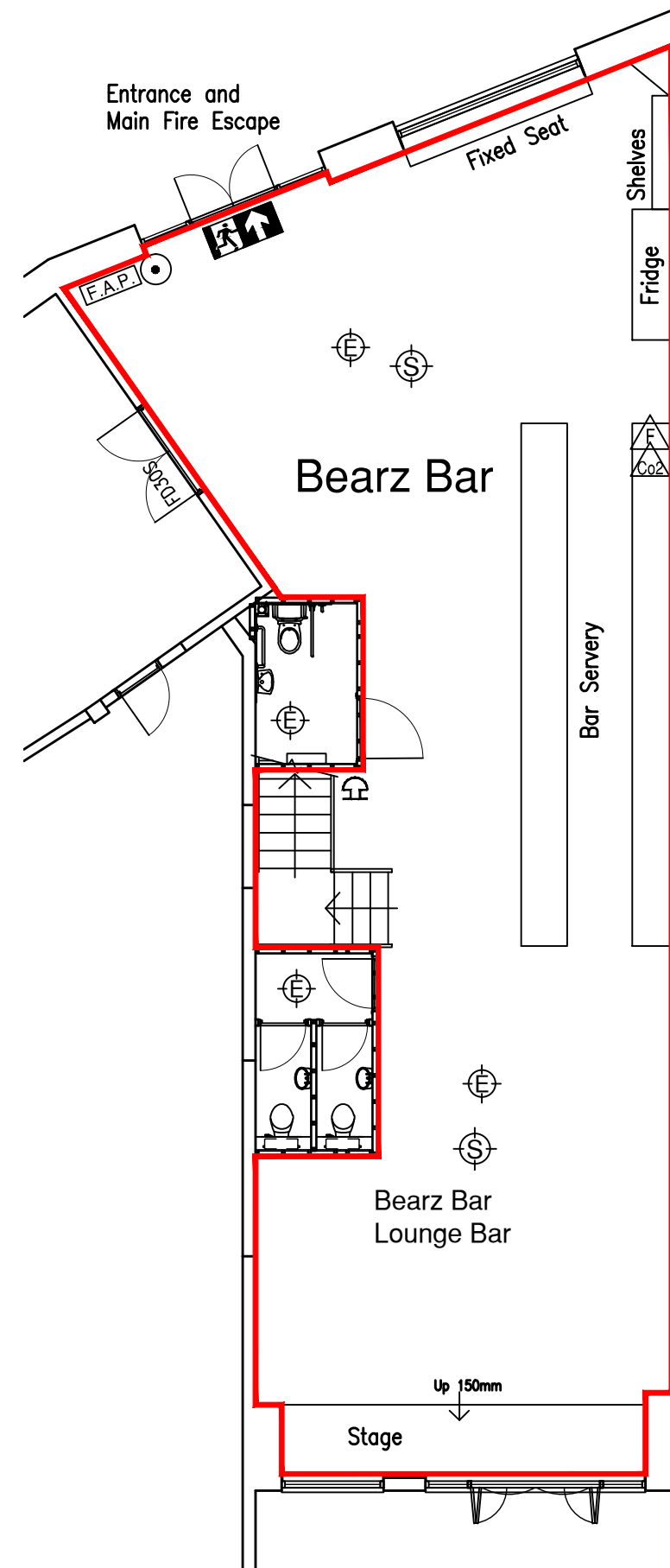

Ground Floor Plan

- FIRE PRECAUTIONS - FITTINGS**
- Emergency Light.
  - Smoke Detector
  - Heat Detector
  - Fire Exit Sign
  - Fire Extinguisher - Wet Chemical
  - Fire Extinguisher - Foam
  - Fire Extinguisher - CO2
  - Fire Blanket
  - Alarm Call Point
  - FD30S 'Fire Door - Keep Shut' sign.
  - Alarm Sounder
  - Fire Alarm Panel

**NOTES**  
 This drawing is the copyright of DESIGN COALITION and cannot be reproduced in any form without the written consent of the company. Written and scaled dimensions to be checked on site, and any discrepancies reported prior to work commencing. IF IN DOUBT PLEASE ASK

**REVISIONS**

REV	DATE	BY	DESCRIPTION

THE OLD MILL, CASTLE STREET  
 ONGAR, ESSEX CM5 9JY  
 TELEPHONE (01277) 388000  
 E MAIL FIRSTNAME@DESIGNCOALITION.CO.UK



**PROJECT**  
 Bearz Bar  
 Island Street, Salcome

**CLIENT**  
 The Kidz and Co

**TITLE**  
 Floor Plans  
 Proposed Layouts  
 Licensing Plan

<b>DATE</b> Jan 18	<b>DRAWN</b> EAL	<b>SCALE (A3 Size)</b> 1:100
-----------------------	---------------------	---------------------------------

<b>DRAWING NUMBER</b> 2811-103	<b>REVISION</b>
-----------------------------------	-----------------